

FELTON

DESIGNER RANGE

MAY 2017



Trusted by New Zealand plumbers and homeowners

For more than 40 years, the Designer Range centres around the Feltonmix™ shower mixer. The first shower mixer to apply the Venturi principle to successfully mix hot and cold water supplied at different pressures, it continues to prove its reliability and performance time and time again.

Proudly Designed and Made in New Zealand

CONTENTS

OUR STORY	02
DESIGNER III RANGE	03
PRODUCTS	04
Designer III	04
Designer II	12
Feltonmix Technology	18
Mixing Valves	20
Spare Parts	24
Quick Guide	26



OUR STORY

Established by company founder Max Davies in Auckland in 1968 from humble beginnings on Felton Matthew Ave, Glen Innes. Just like in the good old days, all Felton products are proudly designed and finished in New Zealand - a breeding ground for innovation and design.

Felton is proud to have some of the best designers in the industry who are constantly striving for perfection and pushing water technology to the next level.

With a vested interest in the environment and increasing efficiencies, one of Felton's main areas of focus is water-saving products.

OUR STANDARDS

From design to dispatch, our procedures are audited by SAI Global (Telarc) and comply with ISO9001. Our ISO9001 certification confirms our commitment to quality management systems, as well as demonstrating our willingness to improve efficiency in order to deliver better products & services to our customers.

The Watermark certification is a mark of quality that confirms our products meet the relevant NZ / AUS plumbing and building industry standards.

INTRODUCING DESIGNER III RANGE



Since 1968, Kiwis have tried, tested and loved the Feltonmix™

We are proud to introduce our new Designer III wallset to give your existing Feltonmix™ a modern, refreshed look. Easily update the look and feel of your bathroom in minutes, without removing the wall lining.

Available in fresh new colour ways, the Designer III wallset features a wider faceplate for retrofit situations (without the need for an adaptor plate) and a uniquely designed showerhead with extra wide spray for maximum comfort and coverage. With nozzles made from limescale resistant rubber for anti-clogging and minimising build up, there is no need to worry about keeping it clean.

Proudly Designed and Made in New Zealand



DESIGNER III FELTONMIX™ SHOWER COMBO
UNEQUAL WHITE

D3SCUW

- Suitable for Unequal Pressure only. Mixing valve included
- Limescale resistant rubber nozzles
- Extra wide spray for maximum comfort and coverage
- Shower aperture 42mm²
- Engineered to suit New Zealand water pressures

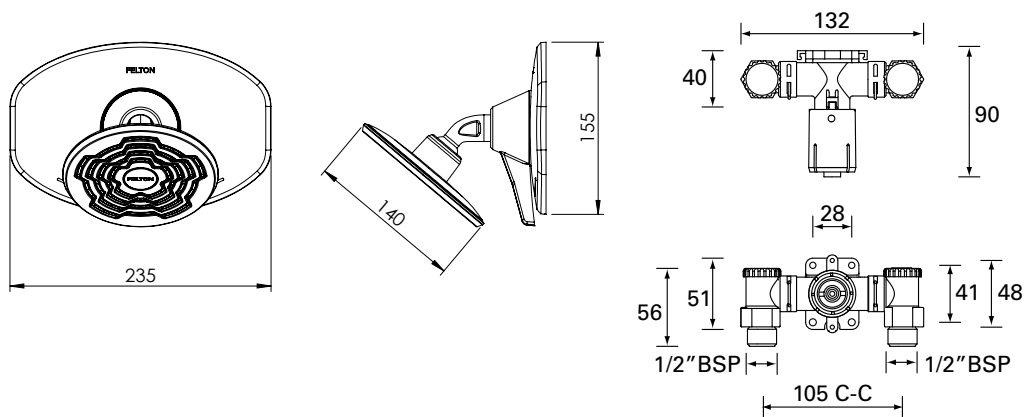

		MIN	MAX	WELS RATING
OPERATING PRESSURES	Unequal	20kPa	COLD 500kPa HOT 150kPa	Low/Unequal ★★★ 9.0L
WATER TEMPERATURE	Hot	55°C	60°C	
	Cold	5°C	NA	



DESIGNER III FELTONMIX™ SHOWER COMBO EQUAL HIGH CHROME GREY

D3SCHCG

- Suitable for Equal High (Mains) Pressure only. Mixing valve included
- Limescale resistant rubber nozzles
- Extra wide spray for maximum comfort and coverage
- Shower aperture 42mm²
- Engineered to suit New Zealand water pressures

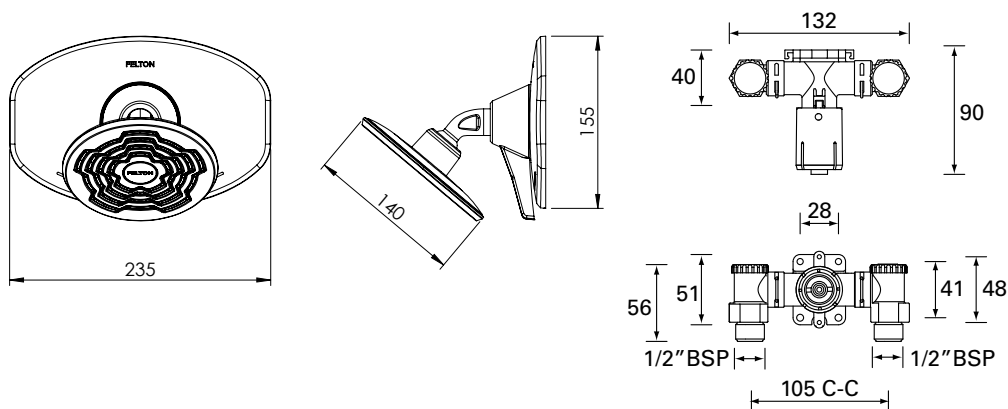

		MIN	MAX	WELS RATING
OPERATING PRESSURES	Equal High	150kPa	500kPa	Equal High (Mains) ★★★ 8.0L
WATER TEMPERATURE	Hot	55°C	60°C	
	Cold	5°C	NA	



DESIGNER III FELTONMIX™ WALLSET WHITE

D3WSW

- Suitable for All Pressures
- Mixing valve not included
- Limescale resistant rubber nozzles
- Extra wide spray for maximum comfort and coverage
- Shower aperture 42mm²
- Engineered to suit New Zealand water pressures

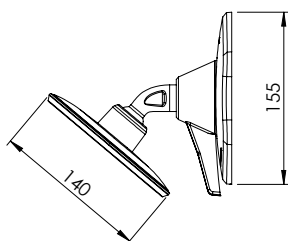
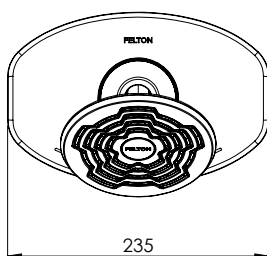

WELS RATING		
Low/Unequal	★★★	9.0L
Equal High (Mains)	★★★	8.0L



DESIGNER III FELTONMIX™ WALLSET WHITE TEAL

D3WSWT

- Suitable for All Pressures
- Mixing valve not included
- Limescale resistant rubber nozzles
- Extra wide spray for maximum comfort and coverage
- Shower aperture 42mm²
- Engineered to suit New Zealand water pressures

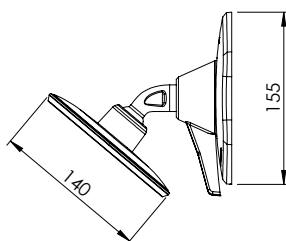
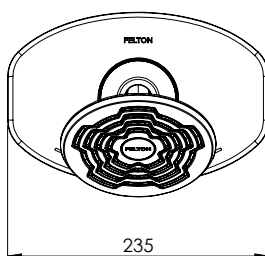

WELS RATING		
Low/Unequal	★★★	9.0L
Equal High (Mains)	★★★	8.0L



DESIGNER III FELTONMIX™ WALLSET CHROME GREY

D3WSCG

- Suitable for All Pressures
- Mixing valve not included
- Limescale resistant rubber nozzles
- Extra wide spray for maximum comfort and coverage
- Shower aperture 42mm²
- Engineered to suit New Zealand water pressures

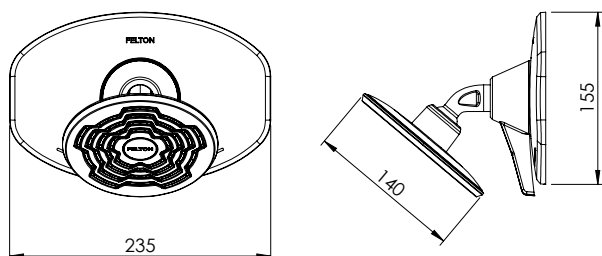

WELS RATING		
Low/Unequal	★★★	9.0L
Equal High (Mains)	★★★	8.0L

TURN YOUR WALLSET INTO A SLIDE SHOWER



If you have an existing Designer Wallset, you can convert it into a Designer Slide Shower by following these simple steps:

- Purchase a Designer slide shower/hand shower kit and install the rail or bracket as per instructions provided with pack.
- Undo shower head on existing wallset by gripping stem and turning anti-clockwise.
- Screw the elbow* end with the black 'O' ring into mixer.
- Screw the hose onto the elbow and handpiece, and attach handpiece.

Note: If a Felton plastic elbow is not supplied with your slide shower, it can be purchased separately (product code EC). Other elbows cannot be screwed into the wallset.

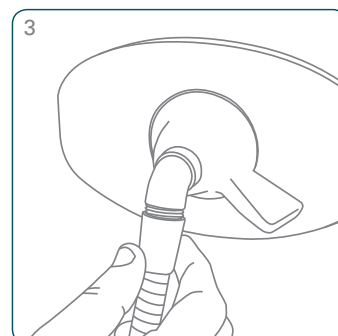
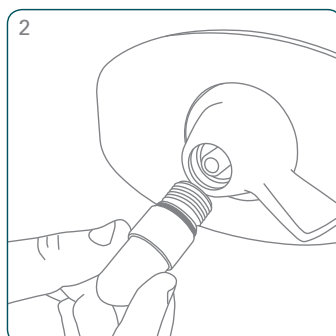
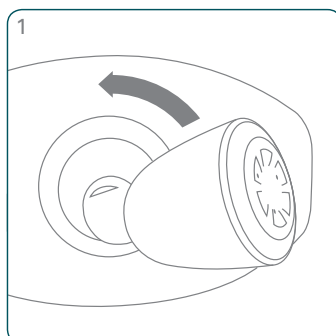





DESIGNER III SHOWER HEAD CHROME GREY DELUXE

D3SHCGD

- Suitable for All Pressures
- Oxijet watersaving device included
- Optimised to be used with Oxijet™ watersaving products for mains pressure
- Shower aperture - 42mm²
- Quality brass arm. NB: Not to be fitted into Feltonmix Mixing Valve
- Limescale resistant rubber nozzles
- Extra wide spray for maximum comfort and coverage

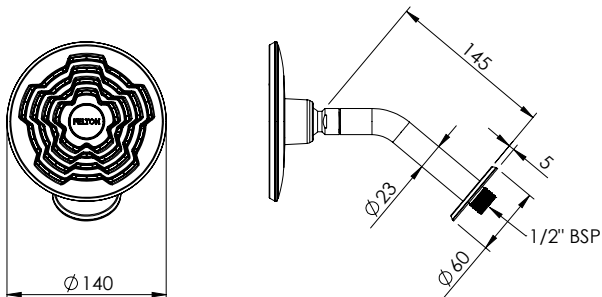

WELS RATING		
Low/Unequal	★★★	9.0L
Equal High (Mains)	★★★	7.0L

Read more about the Oxijet - www.felton.co.nz/oxijet

DESIGNER II



DESIGNER II FELTONMIX™ WALLSET WHITE

WWSD2



- For All Pressures
- Shower aperture - 12mm²
- Mixing valve not included
- TPR rings for ease of cleaning
- Tool included for disassembling wallset
- Watermark certified

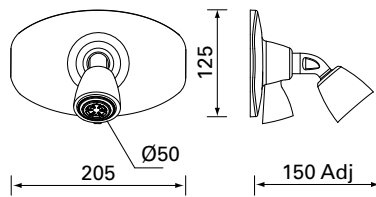

WELS RATING			
Low/Unequal	★★★	9.0L	
Equal High (Mains)	★★★	7.0L	

DESIGNER II FELTONMIX™ WALLSET CHROME

CWSD2



- For All Pressures
- Shower aperture - 12mm²
- Mixing valve not included
- TPR rings for ease of cleaning
- Tool included for disassembling wallset
- Watermark certified

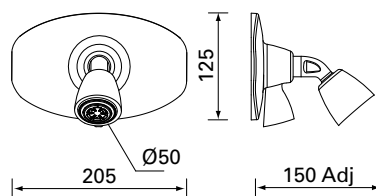

WELS RATING			
Low/Unequal	★★★	9.0L	
Equal High (Mains)	★★★	7.0L	



DESIGNER II SHOWER HEAD CHROME

CSHD2

- For All Pressures
- Shower aperture - 12mm²
- When fitting shower heads, elbows or diverter to standard BSP threads (15mm as per 1986 mixers, thread tape is required to ensure a tight seal.
- Watermark certified

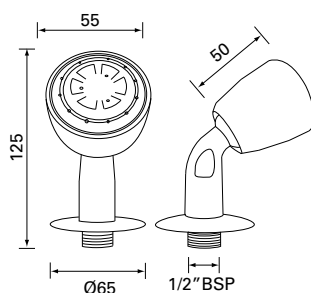

WELS RATING		
Low/Unequal	★★	12.0L
Equal High (Mains)	★★★	7.5L



DESIGNER II SHOWER HEAD WHITE

WSHD2

- For All Pressures
- Shower aperture - 12mm²
- When fitting shower heads, elbows or diverter to standard BSP threads (15mm as per 1986 mixers, thread tape is required to ensure a tight seal.
- Watermark certified

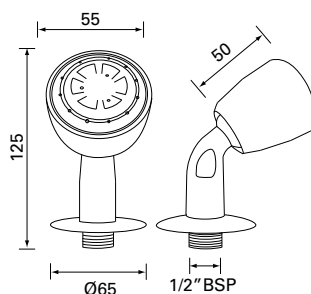

WELS RATING		
Low/Unequal	★★	12.0L
Equal High (Mains)	★★★	7.5L

'86 SHOWER HEAD WHITE

WSH



- For All Pressures
- Shower aperture - 30mm²
- When fitting shower heads, elbows or diverter to standard BSP threads (15mm as per 1986 mixers, thread tape is required to ensure a tight seal.
- Watermark certified

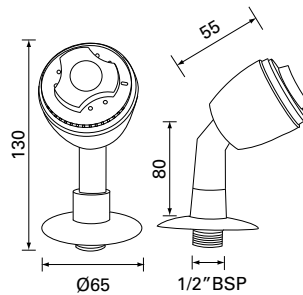

WELS RATING		
Low/Unequal	★	14.0L
Equal High (Mains)	★★★	7.0L

VARIABLE SHOWER HEAD WHITE

WSHV



- For All Pressures
- Flow adjustable
- When fitting shower heads, elbows or diverter to standard BSP threads (15mm as per 1986 mixers, thread tape is required to ensure a tight seal.

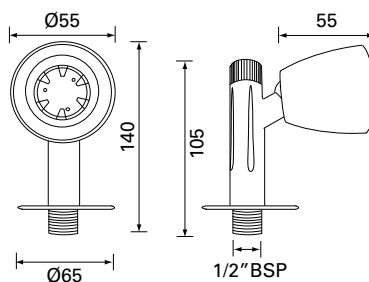

WELS RATING		
Low/Unequal	★★	11.0L
Equal High (Mains)	★★★	7.0L



DESIGNER II SINGLE SPRAY SLIDE SHOWER

D2HSKCSR

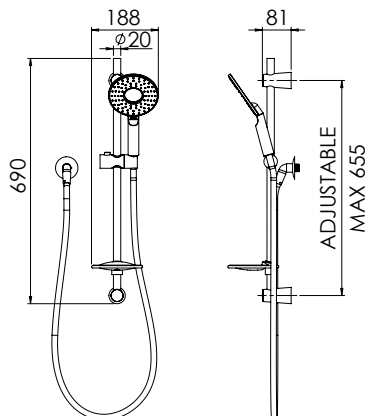

- For All Pressures
- Single function handpiece
- Shower aperture - 38mm²
- Easy DIY conversion to fit onto an existing Feltonmix wallset by replacing existing shower head with elbow supplied
- 690mm adjustable slide rail (max 655mm C-C)
- Soap dish included
- 1.5m large bore EN1113 rated metal hose



WELS RATING		
Low/Unequal	★★★	7.5L
Equal High (Mains)	★★	9.5L



DESIGNER II FLEXISHOWER

D2FSCCSR

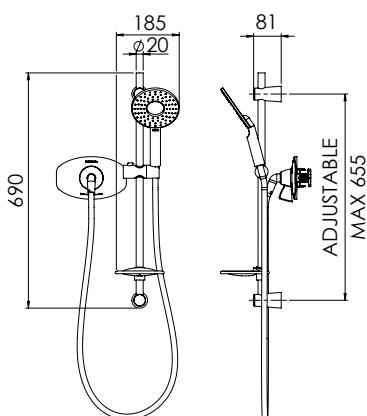

- For All Pressures
- Single function handpiece
- Shower aperture - 38mm²
- Feltonmix wallset and mixing valve included - please specify pressure valve type on order
- 690mm adjustable slide rail (max 655mm C-C)
- Soap dish included
- 1.5m large bore EN1113 rated metal hose



WELS RATING		
Low/Unequal	★★★	7.5L
Equal High (Mains)	★★	9.5L



DESIGNER OVER THE BATH SHOWER UNIT

RW

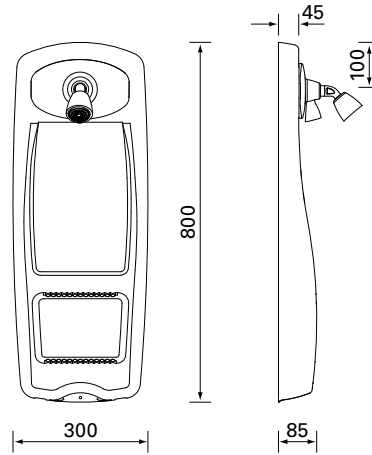

- For Unequal Pressure only
- Shower aperture - 12mm²
- Designed to convert an existing bath into a bath/shower. Attaches to taps without an expensive installation, requires only the simplest of tools.
- Mixing valve included - please specify pressure valve type on order
- Taps not included
- Incorporates a roomy shower caddy. Adaptor cover and bush included

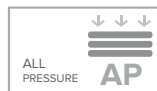

WELS RATING		
Low/Unequal	★★★	12.0L
Equal High (Mains)	★★★★	7.5L



DESIGNER SURFACE MOUNT PACK

WSMP

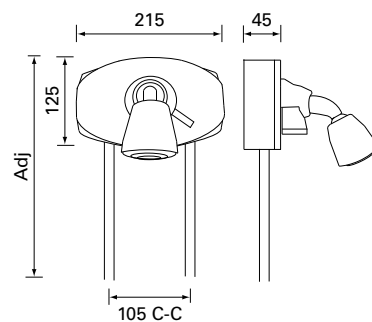

- For All Pressures
- Designed for mounting onto a solid concrete or block wall
- Shower aperture - 12mm²
- Can also be used to convert from a bath situation, where an integral caddy is not required.
- Feltonmix wallset and mixing valve included - please specify pressure valve type on order



WELS RATING		
Low/Unequal	★★★	12.0L
Equal High (Mains)	★★	7.5L

FELTONMIX™ TECHNOLOGY



FELTONMIX™

All pressures, integrated outlet mixer with one point installation for time and cost savings

- Unequal, equal low or equal high (mains) water pressure
- Shallow/standard wall depth
- Low-mid range bathroom budget
- You want to save time and cost with a single point installation (without a separate outlet to an elbow)
- You need the option to convert your bath to a shower without removing the wall lining
- You want the option of changing from a fixed rose to a hand shower or vice versa without having to change the pipe work
- You need a child tamper-proof shower with the temperature control at adult head height

SUITABLE FOR



PRESSURE

MIN
20 KPA
MAX
500 KPA

PRICING



LOW - MID RANGE

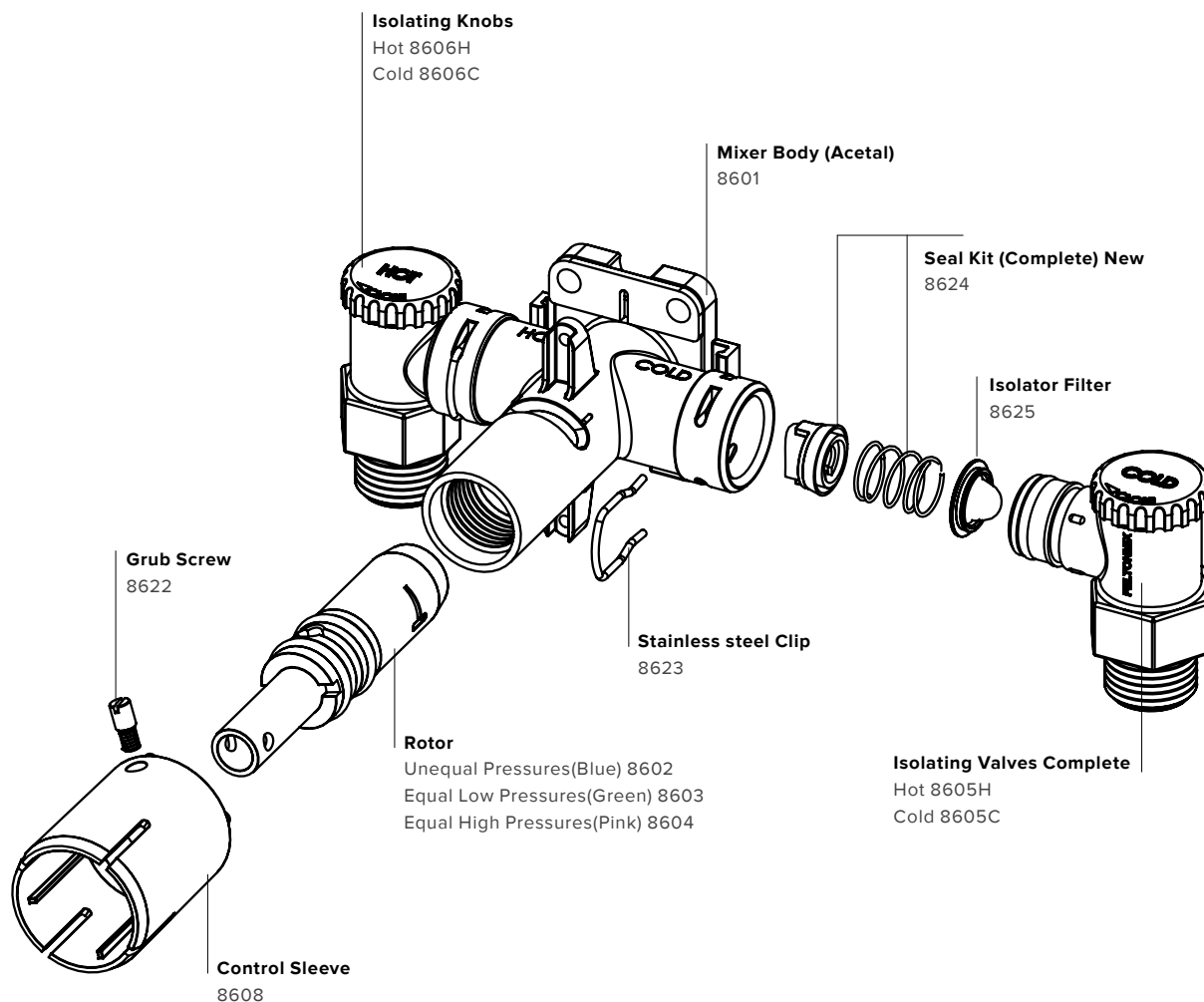

HELP! THE FELTONMIX IS LEAKING! WHAT SHOULD I DO?

Follow this general guide on how to fix the Feltonmix. Should you find any other issues or leakage, feel free to call us!

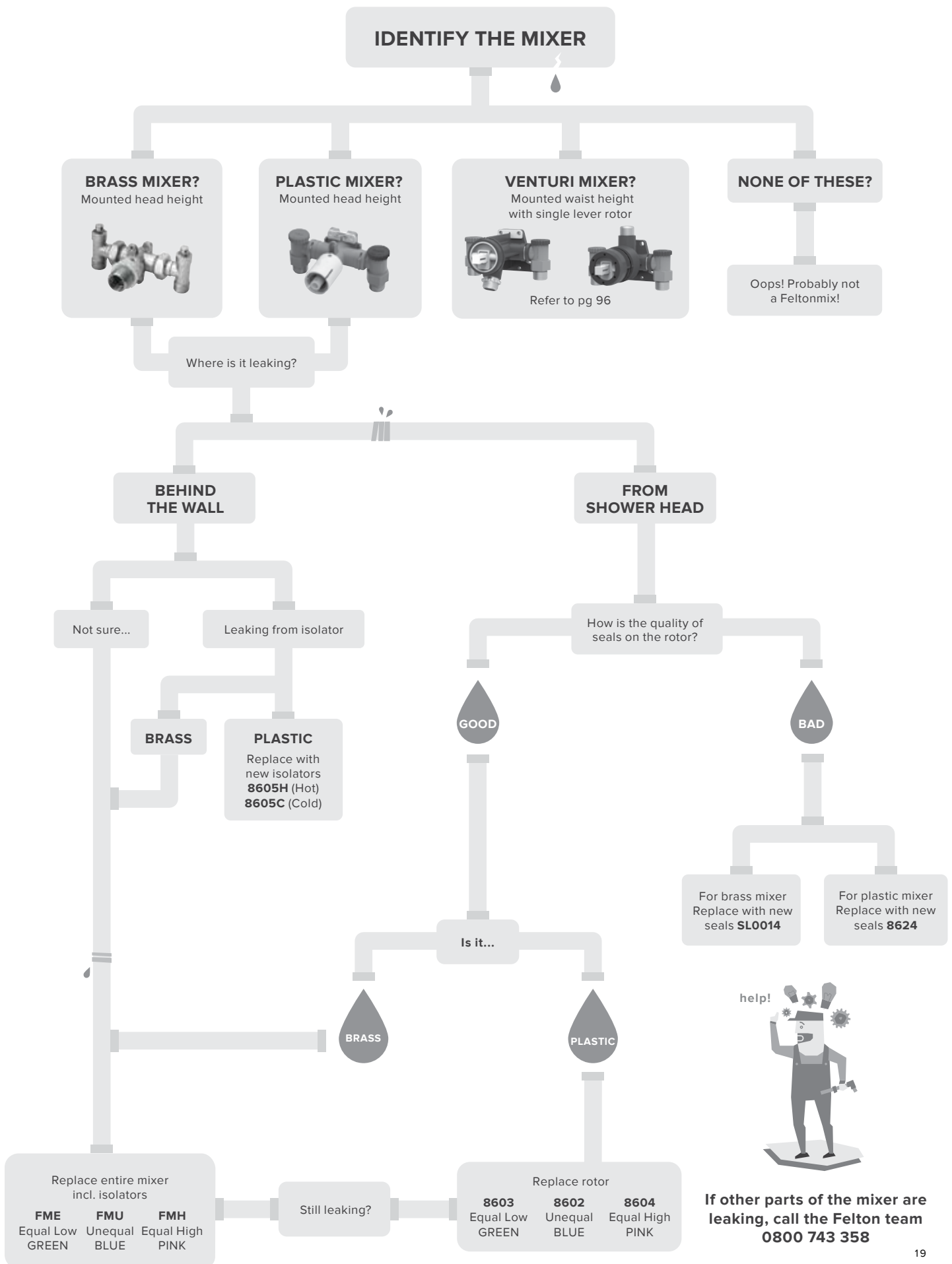

Designer '86 Feltonmix™ Mixing Valve Equal High (Pink)

BARCODE **9416858000023**
PART NO. **FMH**

- For Equal High (Mains) Pressure only
- Designed and Made in NZ
- Watermark certified
- Engineered to suit New Zealand water pressures
- 5 year warranty

OPERATING PRESSURES	Equal Low	MIN	MAX
		150kPa	500kPa
WATER TEMPERATURE	Hot	55°C	60°C
	Cold	5°C	NA

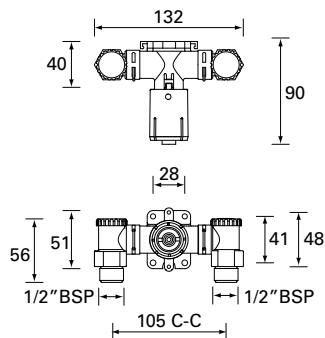

Designer '86 Feltonmix™ Mixing Valve Unequal (Blue)

BARCODE **9416858000030**
PART NO. **FMU**

- For Unequal Pressure only
- Designed and Made in NZ
- Watermark certified
- Engineered to suit New Zealand water pressures
- 5 year warranty

OPERATING PRESSURES	Unequal	MIN	MAX
		20kPa	COLD 500kPa HOT 150kPa
WATER TEMPERATURE	Hot	55°C	60°C
	Cold	5°C	NA

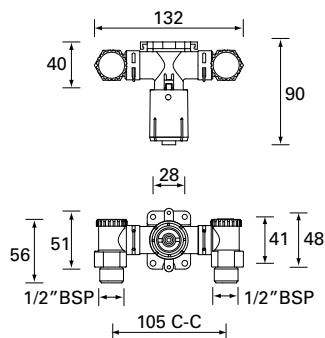

Designer '86 Feltonmix™ Mixing Valve Equal Low (Green)

BARCODE **9416858000016**
PART NO. **FME**

- For Equal Low Pressure only
- Designed and Made in NZ
- Watermark certified
- Engineered to suit New Zealand water pressures
- 5 year warranty

OPERATING PRESSURES	Equal Low	MIN	MAX
		20kPa	150kPa
WATER TEMPERATURE	Hot	55°C	60°C
	Cold	5°C	NA

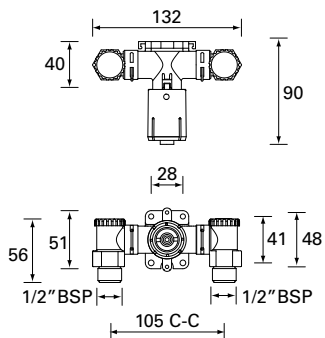

Mixer Body (Acetal)

BARCODE **9416858001327**
PART NO. **8601**

- For Feltonmix shower mixers
- Designed and Made in NZ
- 5 year warranty



Rotors

	Unequal (Blue)	Equal Low (Green)	Equal High (Pink)
BARCODE	9416858001334	9416858001341	9416858001358
PART NO.	8602	8603	8604

- For Feltonmix shower mixers
- Designed and Made in NZ
- 5 year warranty

**Isolating Valves Complete**

	Hot	Cold
BARCODE	9416858001372	9416858001365
PART NO.	8605H	8605C

- For Feltonmix shower mixers
- Designed and Made in NZ
- 5 year warranty

**Isolating Knobs**

	Hot	Cold
BARCODE	9416858002164	9416858002171
PART NO.	8606H	8606C

- For Feltonmix shower mixers
- Designed and Made in NZ
- 5 year warranty

**Control Sleeve**

BARCODE	9416858001389
PART NO.	8608

- For Feltonmix shower mixers
- Designed and Made in NZ
- 5 year warranty

**'O' Ring Rotor**

BARCODE	9416858001402
PART NO.	8614

- For Feltonmix shower mixers
- Designed and Made in NZ
- 5 year warranty



Flow Washers

BARCODE **Hot** **Cold**
 PART NO. **9416858001426** **9416858001433**
 8620 **8621**

- For Feltonmix shower mixers
- Designed and Made in NZ
- 5 year warranty

**Grub Screw**

BARCODE **9416858001440**
 PART NO. **8622**

- For Feltonmix shower mixers
- Designed and Made in NZ
- 5 year warranty

**Stainless Steel Clip**

BARCODE **9416858001457**
 PART NO. **8623**

- For Feltonmix shower mixers
- Designed and Made in NZ
- 5 year warranty

**Seal Kit (Complete) New**

BARCODE **9416858001464**
 PART NO. **8624**

- For Feltonmix shower mixers
- Designed and Made in NZ
- 5 year warranty

**Isolator Filter**

BARCODE **9416858001471**
 PART NO. **8625**

- For Feltonmix shower mixers
- Designed and Made in NZ
- 5 year warranty



Backing Plate Oversize

BARCODE **White**
 PART NO. **9416858090505**
 BPW

BARCODE **Chrome**
 PART NO. **9416858005462**
 BPC

- For Feltonmix shower mixers
- W260 x H180
- Designed and Made in NZ
- 5 year warranty

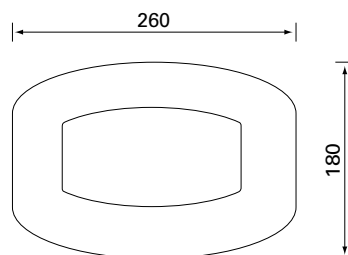
**White Surface Mount Unit**

BARCODE **9416858000764**
 PART NO. **WSM**

- For Feltonmix shower mixers
- Designed and Made in NZ
- 5 year warranty

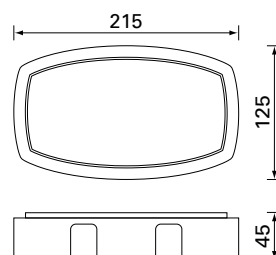
**Washer Kit for Old '86 Mixer Before Year 1986**

BARCODE **9416858007299**
 PART NO. **SL0014**

- For old Feltonmix before year 1986
- Designed and Made in NZ
- 5 year warranty

**Feltonmix™ Designer Adaptor Plate**

BARCODE **White**
 PART NO. **9416858002508**
 WAPD

BARCODE **Chrome**
 PART NO. **9416858002492**
 CAPD

- For Feltonmix shower mixers
- When upgrading from a pre '86 mixer - the adaptor plate packs faceplate the required 7mm off the wall as an alternative to chiselling into the wall
- Designed and Made in NZ
- 5 year warranty

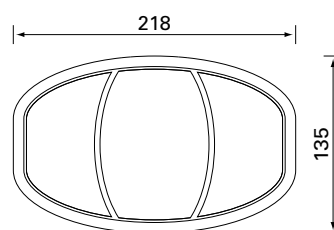
**Anti-Scald Washer**

BARCODE **9416858002195**
 PART NO. **ASW**

- For Feltonmix shower mixers
- Designed and Made in NZ
- 5 year warranty

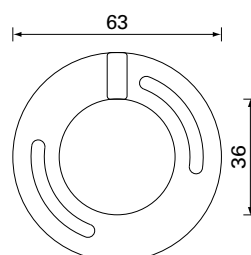

'O' Ring Shower Head Ball

BARCODE **9416858001419**
 PART NO. **8619**

- For Feltonmix shower mixers
- Designed and Made in NZ
- 5 year warranty

**Feltonmix™ Designer Handle**

BARCODE **9416858001730** **9416858001778**
 PART NO. **WHD** **CHD**

- For Feltonmix shower mixers
- Fits Designer, Designer II and 86' faceplates
- Designed and Made in NZ
- 5 year warranty

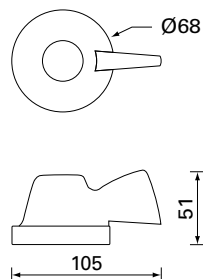
**Feltonmix™ Designer Faceplate**

BARCODE **9416858001792** **9416858001839**
 PART NO. **WED** **CED**

- For Feltonmix shower mixers
- Blank faceplate available on request where fitting a new faceplate to pre '86 mixer (brass), as prior to 1986 showers turned off to left, not the right
- Designed and Made in NZ
- 5 year warranty

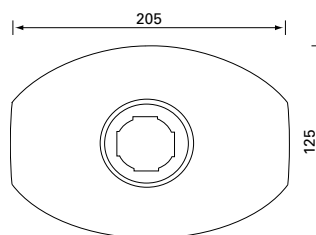
**Diverter**

BARCODE **9416858000382**
 PART NO. **CD**

- For Feltonmix shower mixers
- Designed and Made in NZ
- 5 year warranty

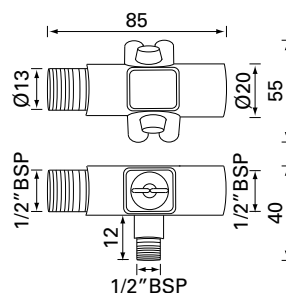

Feltonmix™ Designer III Shower Head

BARCODE	White	White Teal	Chrome Grey
PART NO.	9416858017823 D3SHW	9416858017847 D3SHWT	9416858017830 D3SHCG

- For Feltonmix shower mixers
- Must be paired with Designer III handle
- Designed and Made in NZ
- 5 year warranty

**Feltonmix™ Designer III Shower Head Service Kit**

BARCODE	White	White Teal	Chrome Grey
PART NO.	9416858017854 D3SHSKW	9416858017878 D3SHSKWT	9416858017861 D3SHSKCG

- For Designer III shower heads
- Designed and Made in NZ
- 5 year warranty

**Feltonmix™ Designer III Handle**

BARCODE	White	Chrome
PART NO.	9416858017809 D3WHD	9416858017816 D3CHD

- For Feltonmix shower mixers
- Fits Designer, Designer II, Designer III and 86' faceplates
- Designed and Made in NZ
- 5 year warranty

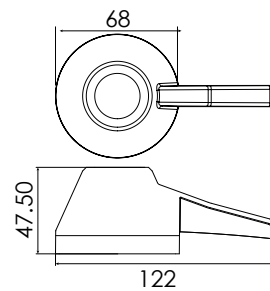
**Feltonmix™ Designer III Faceplate**





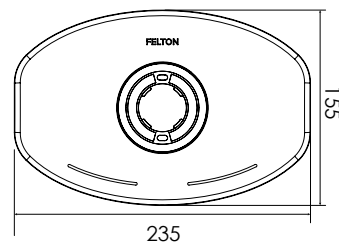







BARCODE	White	Chrome
PART NO.	9416858017786 D3WED	9416858017793 D3CED

- For Feltonmix shower mixers
- Designed and Made in NZ
- 5 year warranty

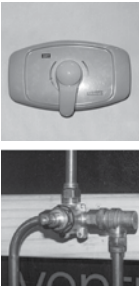

FELTON ADAPTOR FITTINGS

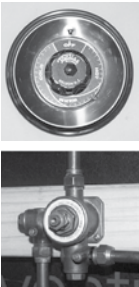
The retrofit parts enable easy conversion without the need to remove existing wet wall linings.

EXISTING	ADAPTOR FITTING	SOLUTION	CONVERT TO NEW PRODUCT
	 <div>1x Retrofit Lining Mount Bracket (VWLMB) 1x Felton Mixer (FMU/FME/FMH)</div>		<div>FELTONMIX™ SHOWER MIXER</div> <div>WWSD2CWSD2</div>  <div>OR</div> <div>D3WSWD3WSWT</div>  <div>D3WSCG</div>  <div>Mixer sold separately</div> <div>OR</div> <div>FELTONMIX™ DESIGNER FLEXISHOWER</div> <div>D2FSCCSR</div>  <div>Mixer included</div>
	 <div>1x Retrofit Nipple (VSMRN) 1x Retrofit Plug (VSRRP) 1x Felton Mixer (FMU/FME/FMH)</div>		
	 <div>1x Retrofit Pipe (VSMRP) - for Feltonmix™ Mixer only 1x Retrofit Plug (VSRRP) 1x Felton Mixer (FMU/FME/FMH)</div>		



www.felton.co.nz

CALL **0800 743 358**

FAX **0800 329 335**

At Felton we care about our customers, our people and our planet. We are passionate about enhancing lives with innovative products. Felton products combine unique water technologies with a focus on the end user.

To find out more visit our website or follow us on social media.

FELTON DESIGNER BROCHURE

Effective May 2017. Products may on rare occasions differ slightly from literature and illustrations.

Felton Industries Limited reserves the right to incorporate product changes and improvements without prior notice.



FELTON INDUSTRIES LTD

8 Farmhouse Lane Glen Innes Auckland 1072

sales@felton.co.nz | Find us on Facebook