

PRODUCT FINISHES

Care Instructions

FELTON

Caution:

This product is manufactured using stainless steel. Care should be taken when using the shower as damage to surroundings may occur if the product is dropped.

About PVD finishes:

PVD stands for 'Physical Vapour Deposition'. This process is forming a thin, bonded, metal, or metal-ceramic surface layer that greatly improves the appearance, durability, and function of a part or product. It is more environmentally friendly than traditional coating processes such as electroplating and painting.

The components are sealed in an airtight chamber and a vacuum is created. In this vacuum, an inert gas such as nitrogen is used as a medium, and the negatively charged tap bodies attract the positively charged metallic particles. Different finishes are achieved by combining different metal 'targets' and gases.

PVD coated products require the same cleaning as any chrome plated products.

How to care for your handpiece:

All bathroom products require some care and attention from time to time.

We recommend using a soft microfibre cloth with a solution of warm water and mild detergent to wipe down the handpiece once a week to keep it looking great.

General cleaning

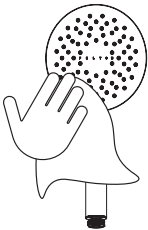

Clean with a soft microfibre cloth

Use a soft microfibre cloth, warm water and mild detergent such as dishwashing liquid to clean your handpiece.

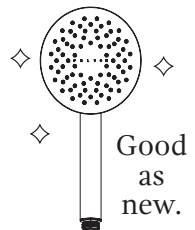

Things to avoid:

Avoid abrasive cleaning solutions and handling the handpiece while wearing/using sharp objects such as rings that could potentially scratch the surface of the handpiece.

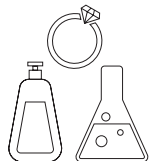

CHOOSING THE AERLUX® JET

For a *softer shower*, install the Orange Aerlux® Jet



With the Flow Regulator fitted

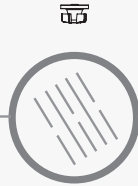

For a *harder shower*, install the Purple Aerlux® Jet



FITTING THE AERLUX® JET FOR THE HANDPIECE

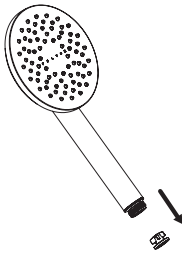

1. Remove the Flow Regulator from the handpiece

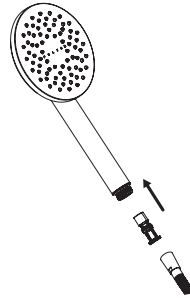

2. Select the Aerlux® Jet and fit into the handpiece before screwing it onto the hose.

FITTING THE AERLUX® JET FOR THE SHOWER ROSE

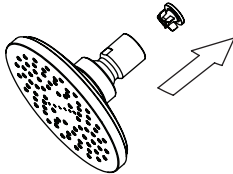

1. Remove the Flow Regulator from the shower rose.

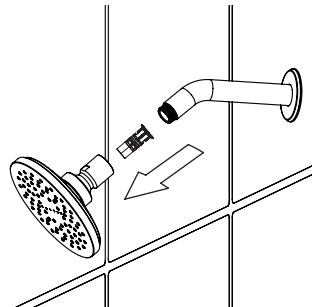

2. Select the Aerlux® Jet and fit into the shower rose before screwing it onto the fixed arm.