

INSTALLATION GUIDE

SOL SINGLE SPRAY SLIDE SHOWER

WHAT IS IN THE PACK

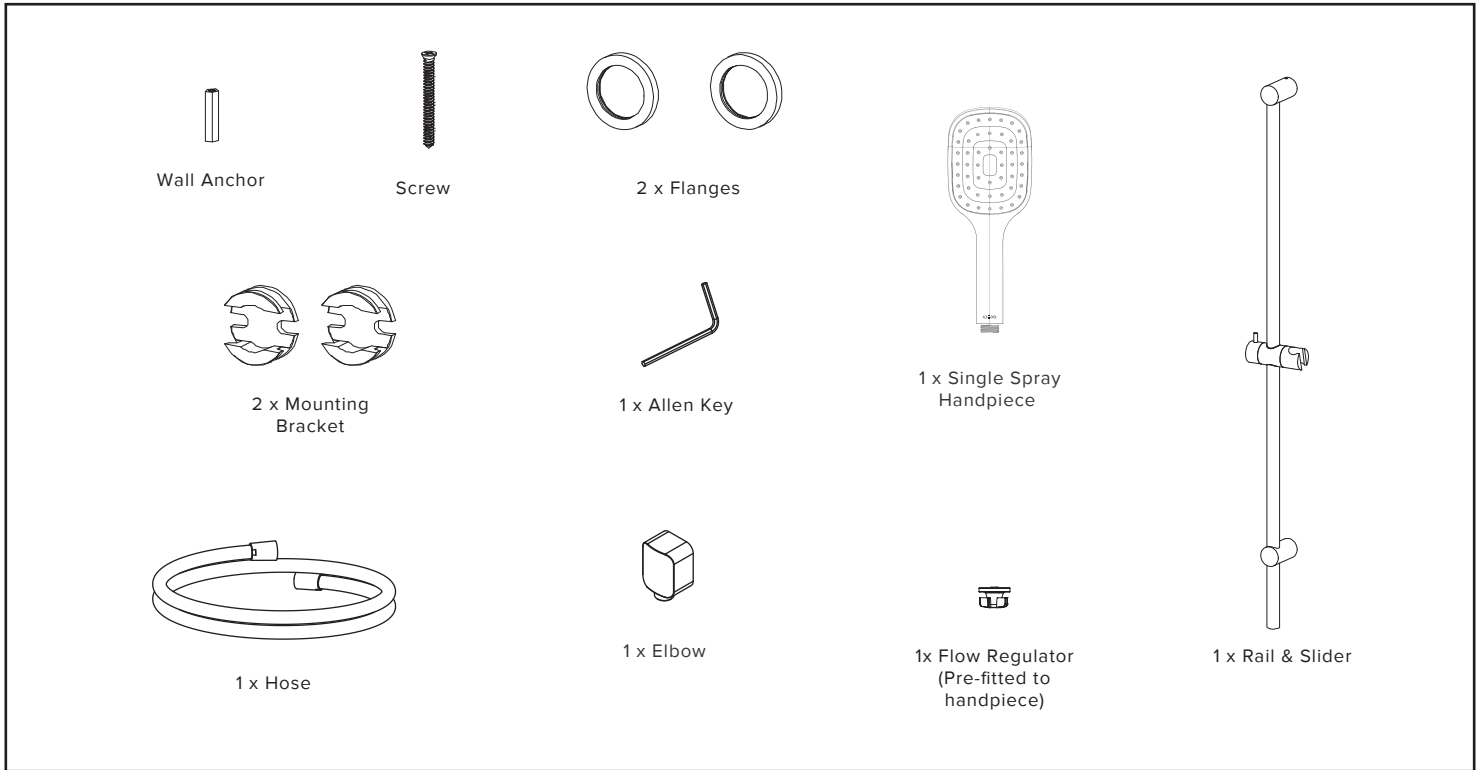

HOW TO INSTALL

INSTALLING INTO STUD/NOG...(RECOMMENDED)

<p>1. Untighten the grub screws from the top and bottom of the rail with a 2.5mm allen key and remove the brackets.</p>	<p>2. Screw the Top Inlet Mounting Bracket onto the water outlet. Sealant is required on thread to achieve a water tight seal. Mount the brackets into the desired position on the wall (adjustable MAX 820mm c-c), ensuring that they are in the correct orientation.</p>	<p>3. Adjust the bottom bracket on the rail, using a 2.5mm allen key to loosen and tighten the grub screw inside the back of the bracket.</p>

<p>4. Fit the flanges over both brackets of the rail. Then mount the rail onto the brackets in place. Ensure that both rail and bracket are secured. It is recommended that silicone sealant be used to seal the fixing brackets.</p>	<p>5. Tighten the grub screws on the rail with an allen key (A). Push the flanges firmly against the wall (B).</p>	<p>6. Screw the elbow into the water outlet (wingback). Sealant required on thread to achieve a water tight seal. Screw the hose onto the elbow.</p>	

<p>INSTALLING INTO CONCRETE/BRICK WALL...</p>		
<p>Pre-drill holes to the desired position (adjustable maximum 820mm c-c) and fit the wall anchors then follow the above instructions.</p>		

IF YOU HAVE...

EQUAL HIGH/MAINS PRESSURE

Fitting the Flow Regulator

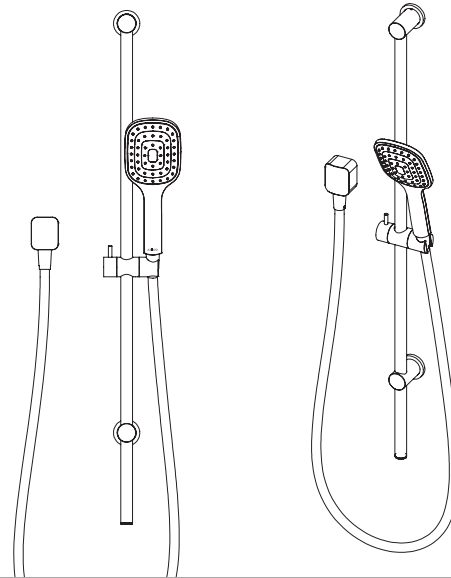
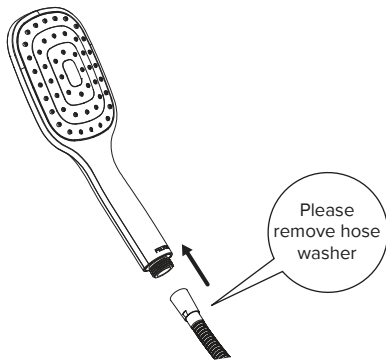

1. Supplied with the Flow Regulator prefitted - attach to the hose and place in slider

EQUAL LOW PRESSURE OR UNEQUAL PRESSURE

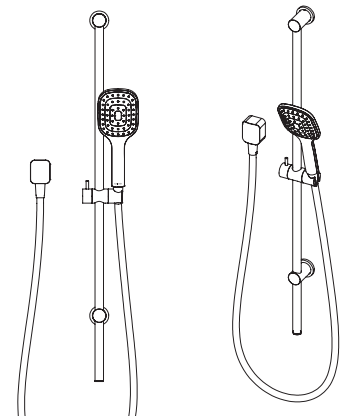
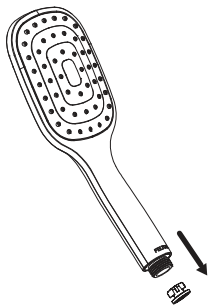

1. Remove the prefitted Flow Regulator from the handpiece...

2. Attach to hose and place in slider