

INSTALLATION GUIDE

ADESSO DEGREE BATH FILLER DBFSMC

ADESSO

SYSTEM REQUIREMENTS

	MINIMUM	MAXIMUM
Equal High (MAINS) Operating Pressures	150kPa	500kPa
Operating Hot Water Temperatures	55° C	60° C
Operating Cold Water Temperatures	5° C	N/A

⚠ Do not plug outlet when testing.

⚠ This mixer is recommended for equal high (mains) pressure water supply only.

To ensure the optimum performance and customer satisfaction please adhere to the following:

- Flush out all pipe work prior to installation.
- Minimum flow pressure for satisfactory operation: (Hot and Cold) 150kPa
- Maximum static water pressure: 500kPa. If the water pressure exceeds or is likely to exceed 500kPa, an approved pressure limiting valve must be fitted.
- Maximum hot water temperature: 60°C. If the water temperature exceeds 60°C, an approved tempering valve must be fitted.
- Installation should comply with relevant local authority requirements.
- In accordance with good plumbing practice, filters should be fitted to supply lines to eliminate damage to the ceramic cartridge from suspended solids.
- AS/NZS 3500.1 states that pressures above 500 kPa can cause damage from water hammer, reduce the life of appliances, taps & fittings, cause excessive noise in the system and recommend that a pressure limiting valve (PLV) be fitted.

⚠ Failure to comply with the above will void all warranties.

WHAT IS IN THE PACK

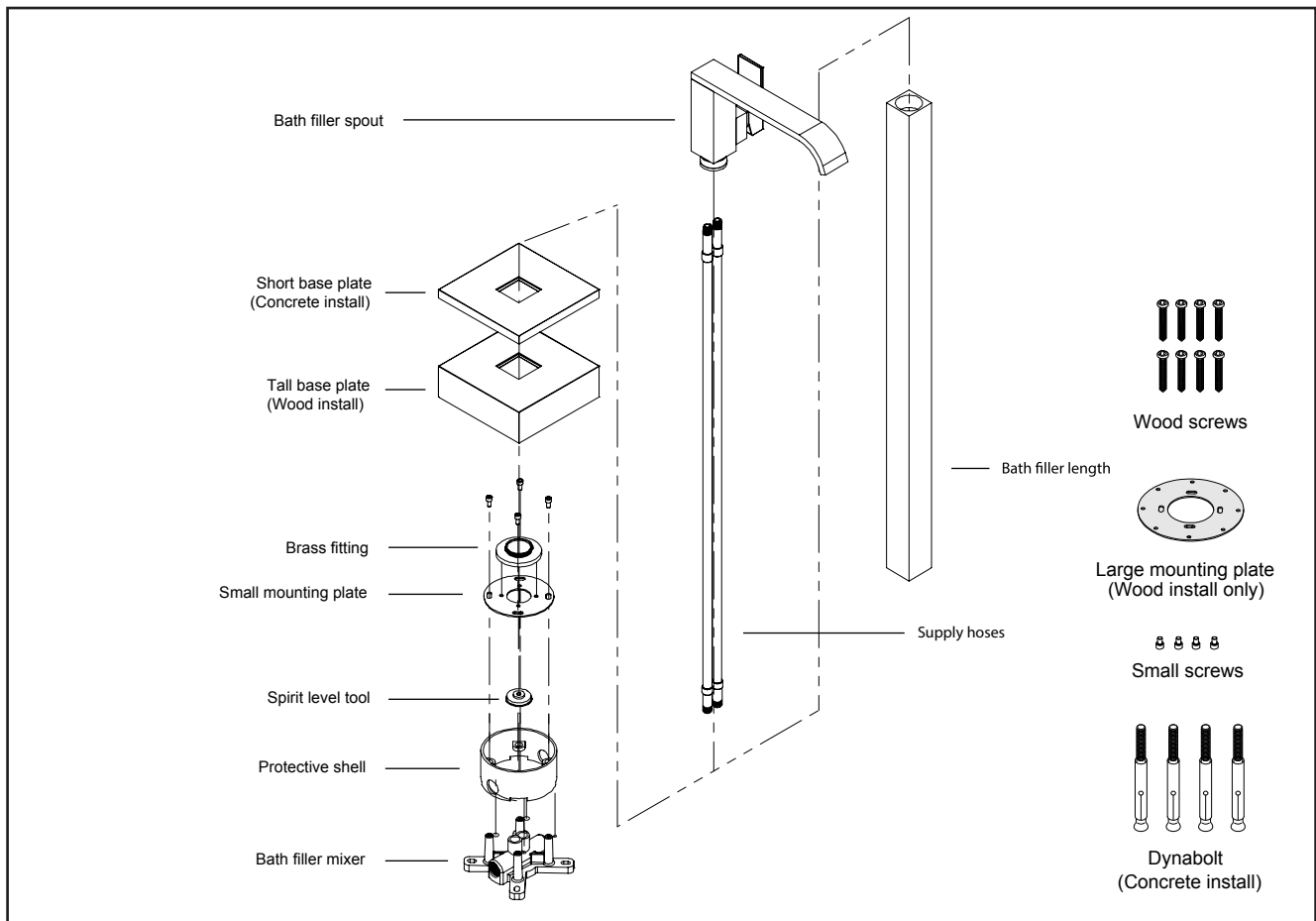

⚠ BEFORE INSTALLATION

Pipework MUST be purged before connecting to the mixer

HOW TO INSTALL ON WOODEN FLOOR

1. Preassemble the above parts in the the same order. Make sure that the tall base plate (D.) is fitted before proceeding.

2. Remove screws, small mounting plate, protective shell and spirit level.

3A. Fix the small mounting plate onto brass fitting from the bottom with screws supplied.
3B. Screw the fitted assembly onto bottom of the bath filler.

4. Using the protective shell as a template to mark the mixer (See Diagram A). With a hacksaw, cut the floor mounting points of the mixer as marked. This is so the mixer will fit in the $\varnothing 100\text{mm}$ hole later in the installation.

5. Fix the bath filler assembly, large mounting plate and mixer together with the supplied screws. Ensure that the supply pipes are aligned and fitted into the mixer before tightening the screws.

6. Before cutting the hole, ensure that there is sufficient depth below the wood floor for the mixer (See Diagram A). With a hole saw, cut a $\varnothing 100\text{mm}$ hole in the wood floor. The hole should not exceed 100mm diameter or there will be insufficient surface area for mounting the large mounting plate ($\varnothing 140\text{mm}$) of the mixer.

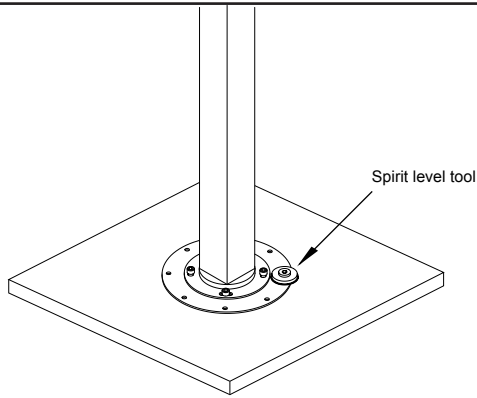

7. Check that the bath filler is level with the supplied spirit level tool.

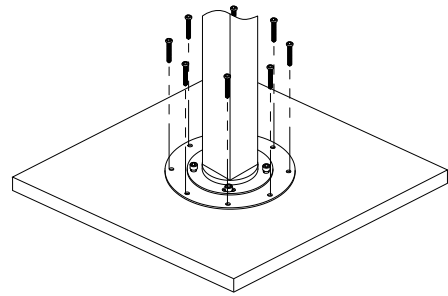

8. Using the 8 supplied wood screws, fix the bath filler into the wood floor.

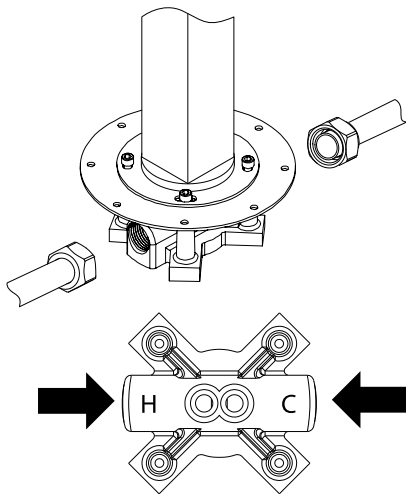

9. Connect the hot and cold water source to the mixer location. Make sure to purge the pipe before connecting to the mixer. Test watertightness.

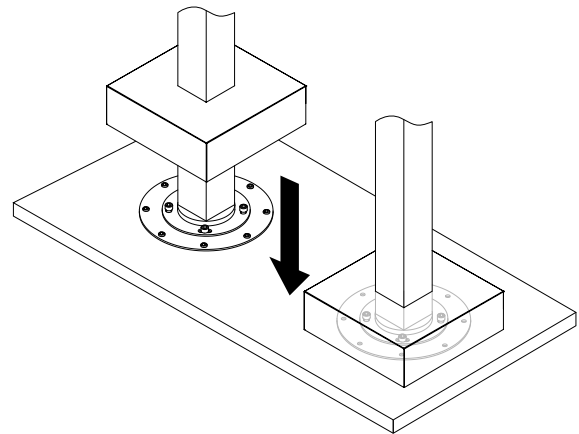

10. Upon completion of floor finish, push the base plate until flush with floor and covering mixer hole. Silicone is optional under the inner edge of the plate.

HOW TO INSTALL ON CONCRETE FLOOR

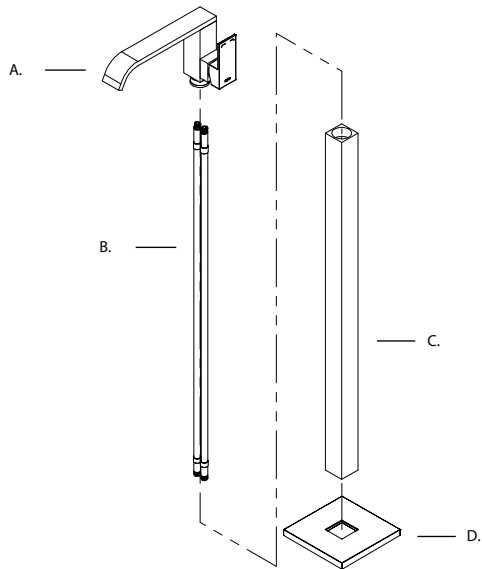

1. Preassemble the above parts in the the same order. Make sure that the short base plate (D.) is fitted before proceeding.

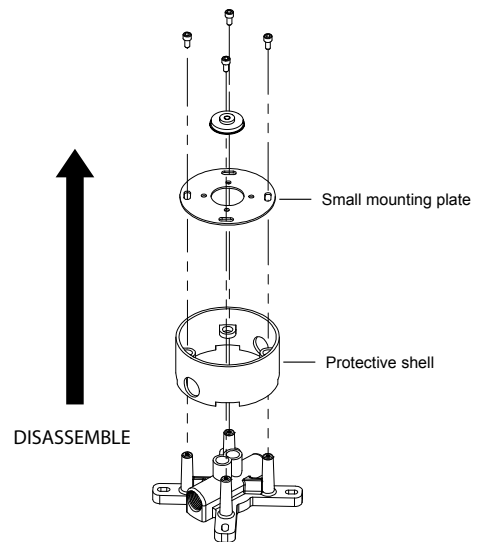

2. Remove screws, small mounting plate, protective shell and spirit level.

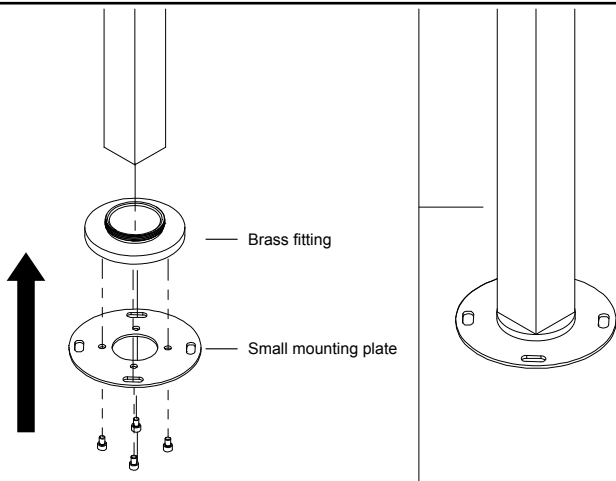

3A. Fix the small mounting plate onto brass fitting from the bottom with screws supplied.
3B. Screw the fitted assembly onto bottom of the bath filler.

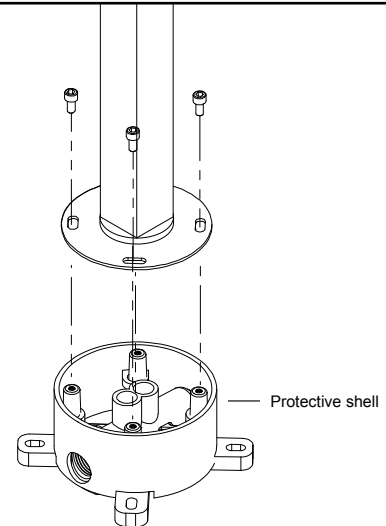

4. Fix the bath filler assembly, protective shell and mixer together with the supplied screws. Ensure that the supply pipes are aligned and fitted into the mixer before tightening the screws.

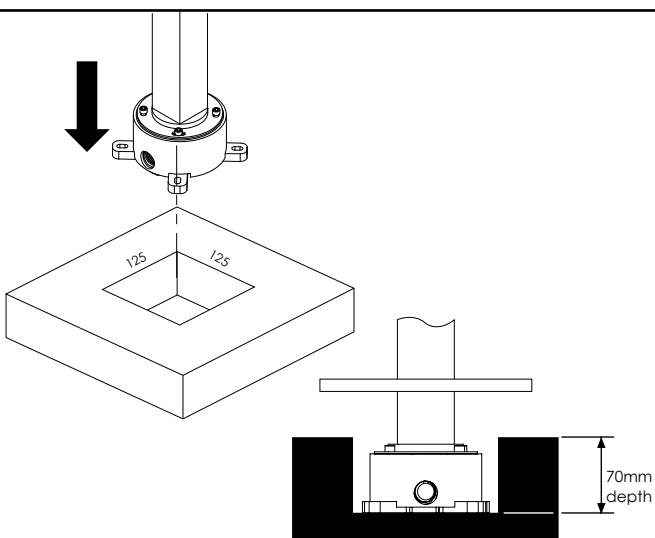

5. Cut a 125 x 125mm hole by 70mm deep into the concrete. Make sure the cut hole provides sufficient space to connect water sources and a level surface for the mixer to be fixed upon. The hole should not exceed 150mm or there will be insufficient surface area for mounting.

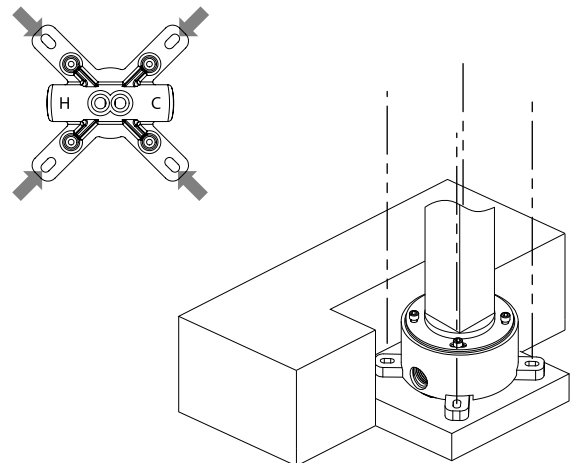

6. With the mixer connect and in the correct position, mark the four floor mounting points of the mixer.

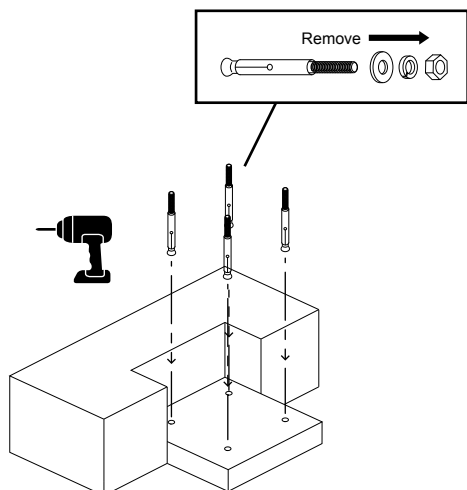

7A. Drill four $\varnothing 8\text{mm}$ x 45mm deep holes in the marked locations.
 7B. Remove the nut and washers from the supplied Dynabolt and fit Dynabolt into each drilled hole.

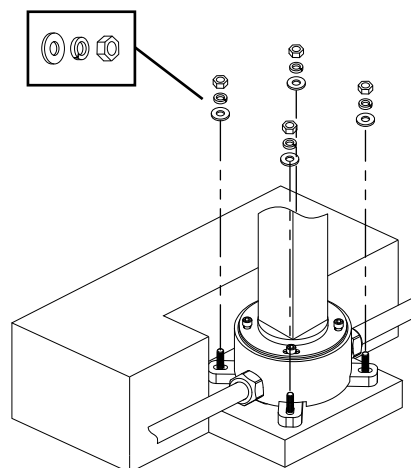

8. Fit the mixer back into position and secure into place with the washer and nut of the Dynabolts.

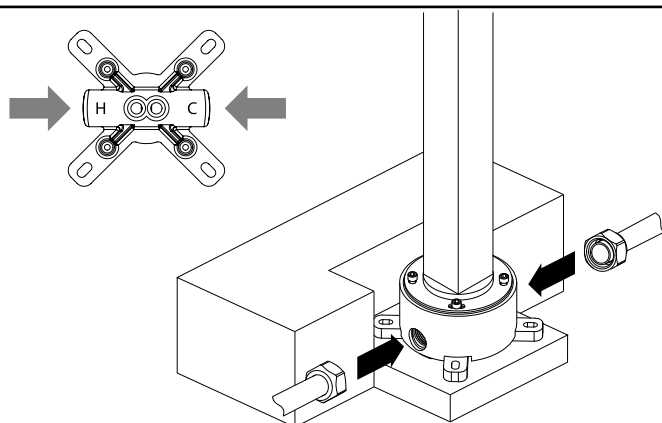

9. Connect the hot and cold water source to the mixer location.
 Make sure to purge the pipe before connecting to the mixer.
 Test water tightness.

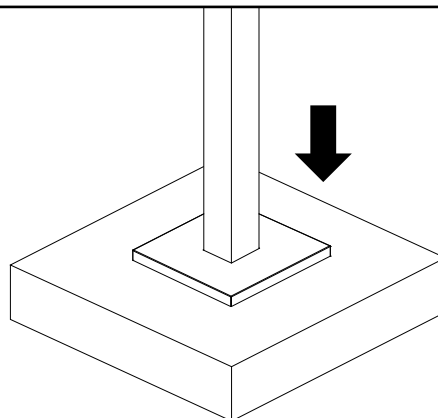

10. Upon completion of floor finish, push the base plate until flush with floor and covering mixer hole. Silicone is optional under the inner edge of the plate.