

INSTALLATION GUIDE

MILA FUSION PLUS SHOWER MIXER DFSPCSMC

SYSTEM REQUIREMENTS

	MINIMUM		MAXIMUM
	Hot	Cold	
Unequal Pressure - Venturi jet installed Operating Pressures - refer to the Venturi Selection Table on page 2	36kPa (5.1psi)	200kPa (29.0psi)	1500kPa (217.6psi)
Equal High (Mains) & Equal Low Pressures - Venturi jet removed Operating Pressures	36kPa (5.1psi)		1500kPa (217.6psi)
Operating Hot Water Temperatures	55° C		60° C
Operating Cold Water Temperatures	5° C		N/A

⚠ Do not plug outlet when testing.

⚠ This shower mixer can be line tested up 1500kPa (217.6psi)

⚠ AS/NZS 3500.1 states that pressures above 500kPa can cause damage from water hammer, reduce the life of appliances, taps & fittings, cause excessive noise in the system and recommend that a pressure limiting valve (PLV) be fitted.

WHAT IS IN THE PACK

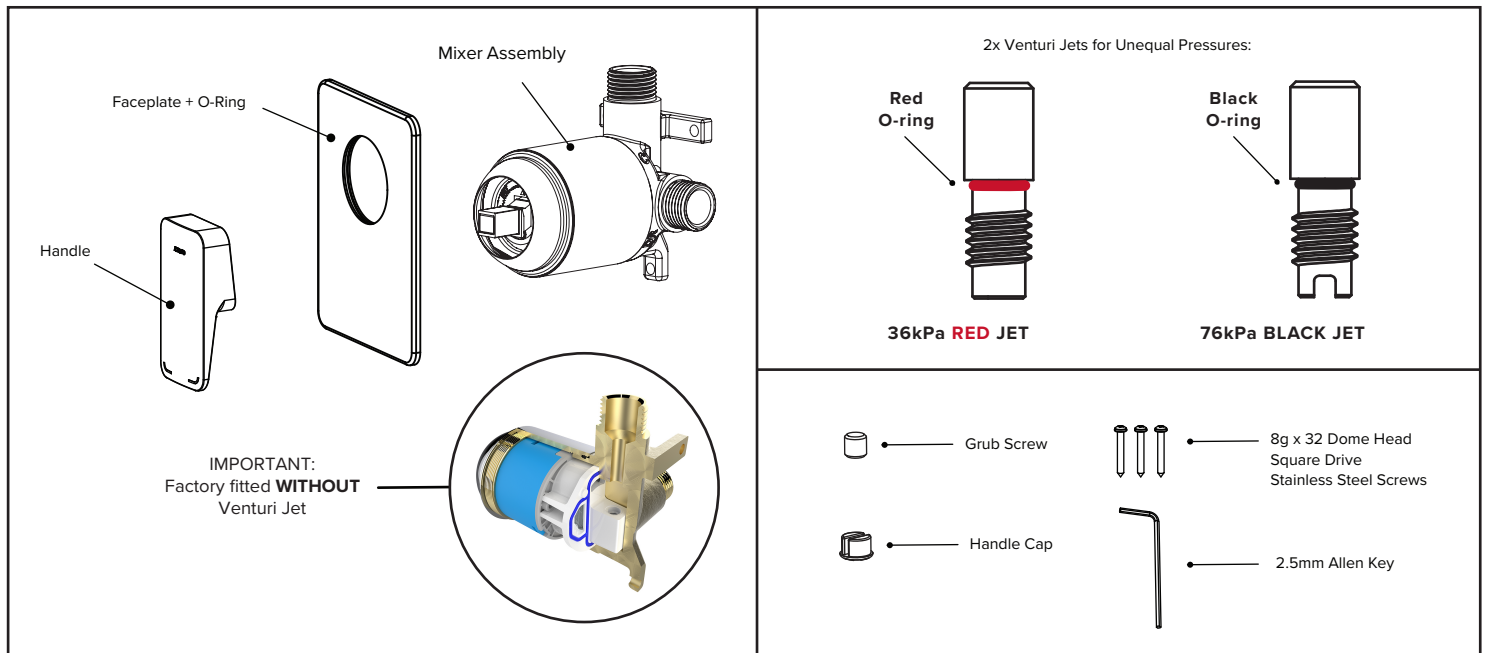

! BEFORE INSTALLATION

Pipework MUST be purged before connecting to the mixer

! MIXER ORIENTATION

This mixer is designed to be connected with the hot water supply on the left only and the cold water supply on the right only.

If at any point the nut is removed, please ensure that both black lines marked on the cartridge and cartridge nut are aligned when the mixer is in full cold position as shown in figure 1.

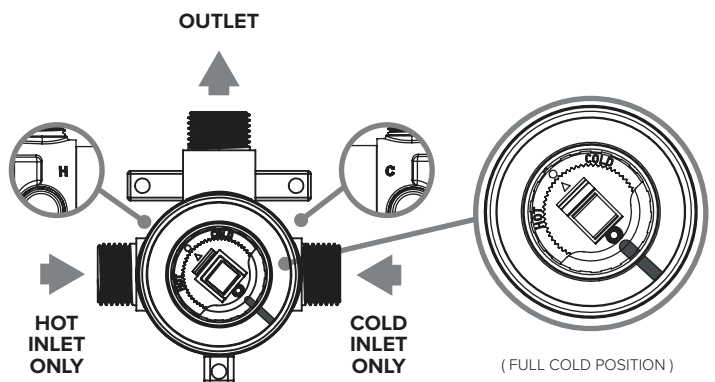
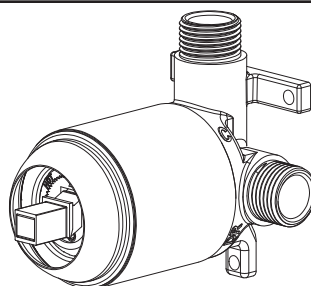

Figure 1.

IF YOU HAVE...

EQUAL LOW PRESSURE OR EQUAL HIGH/MAINS PRESSURE

Install product as supplied.



UNEQUAL PRESSURE

Follow this guide to select the correct Venturi Jet for the pressure situation:

<p>36kPa RED JET Venturi Jet (small hole) Recommended for 36kPa hot water supply.</p>	<p>76kPa BLACK JET Venturi Jet (large hole) Recommended for 76kPa or greater hot water supply.</p>		
Hot Water Pressure	Cold Water Pressure	RECOMMENDED	Notes
Unknown	Unknown	36kPa RED Jet venturi jet (small hole)	The 36kPa RED venturi jet provides the best temperature control with lower pressure hot water supplies.
36kPa hot water pressure	Any	36kPa RED Jet venturi jet (small hole)	
76kPa hot water pressure	Unknown	36kPa RED Jet venturi jet (small hole)	
	Over 500kPa cold water pressure	36kPa RED Jet venturi jet (small hole)	
	150 - 500kPa cold water pressure	76kPa BLACK Jet venturi jet (large hole)	The 76kPa BLACK venturi jet provides the best flow for higher pressure hot water supplies, but if it is difficult to control the temperature, we recommend to change to the 36kPa RED venturi jet (small hole).

Please note: Performance of the mixer will vary based on the specific pipework between your hot water source and the outlet.

INSTALLING THE VENTURI JET

Using the Allen Key provided, screw the Venturi Jet into the inlet thread end first. The Allen Key is a tight fit and will require a hard push to fully engage in the jet.

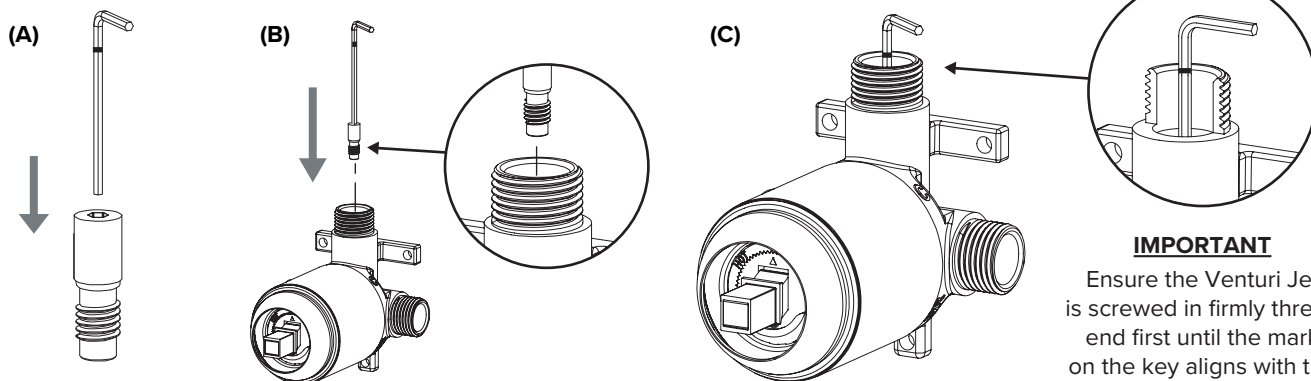

IMPORTANT

Ensure the Venturi Jet is screwed in firmly thread end first until the mark on the key aligns with the end of the mixer outlet.

Please note: Do not throw away the other Venturi Jet as this may be required at a later date and ask the homeowner to keep with the warranty information.

HOW TO INSTALL

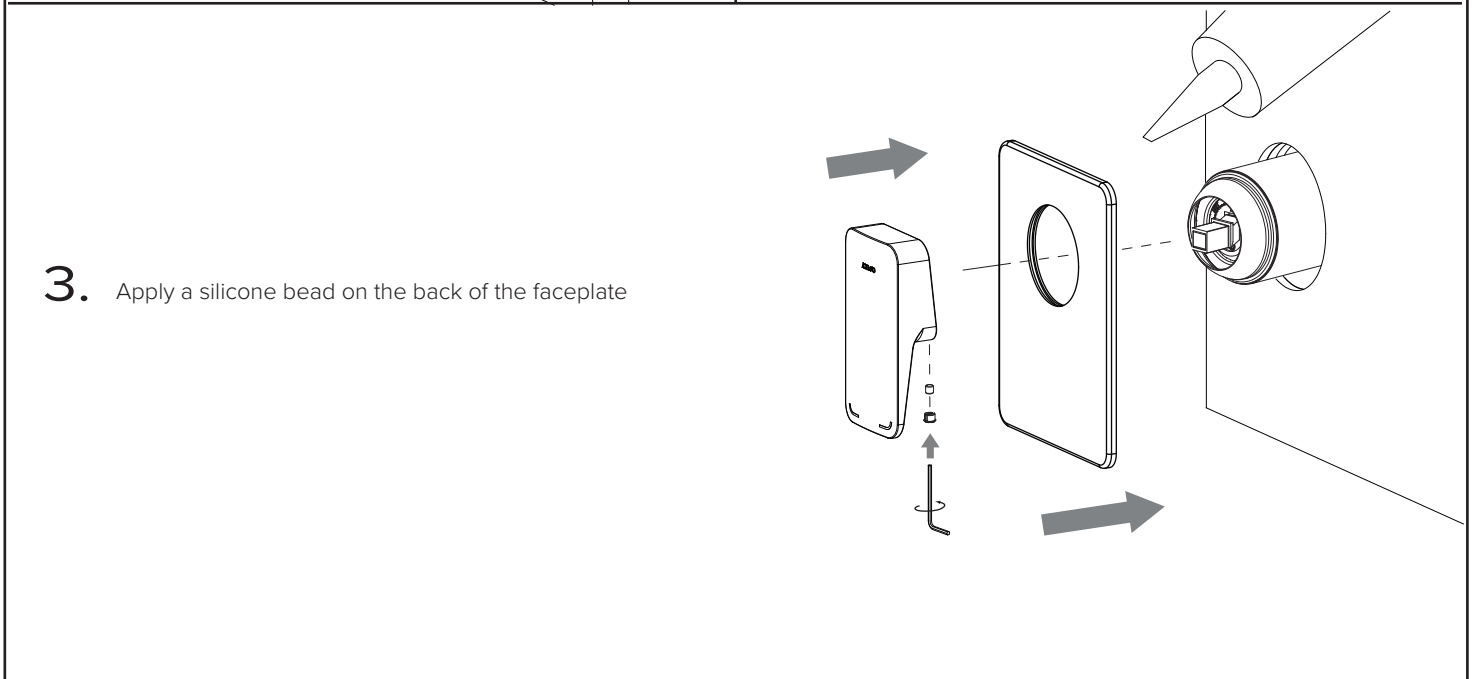
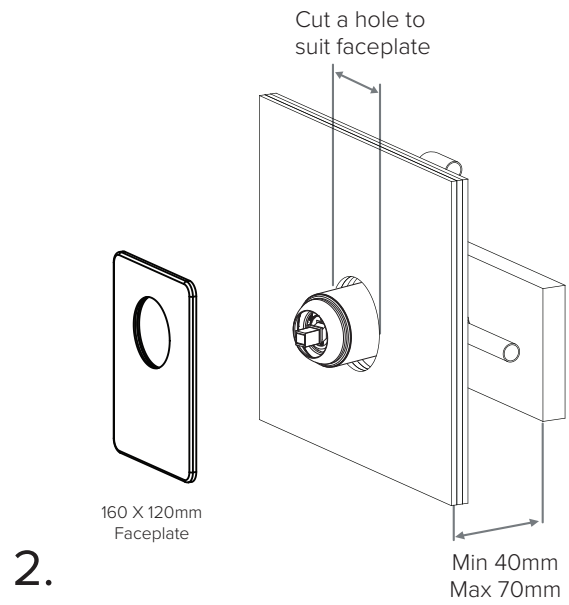
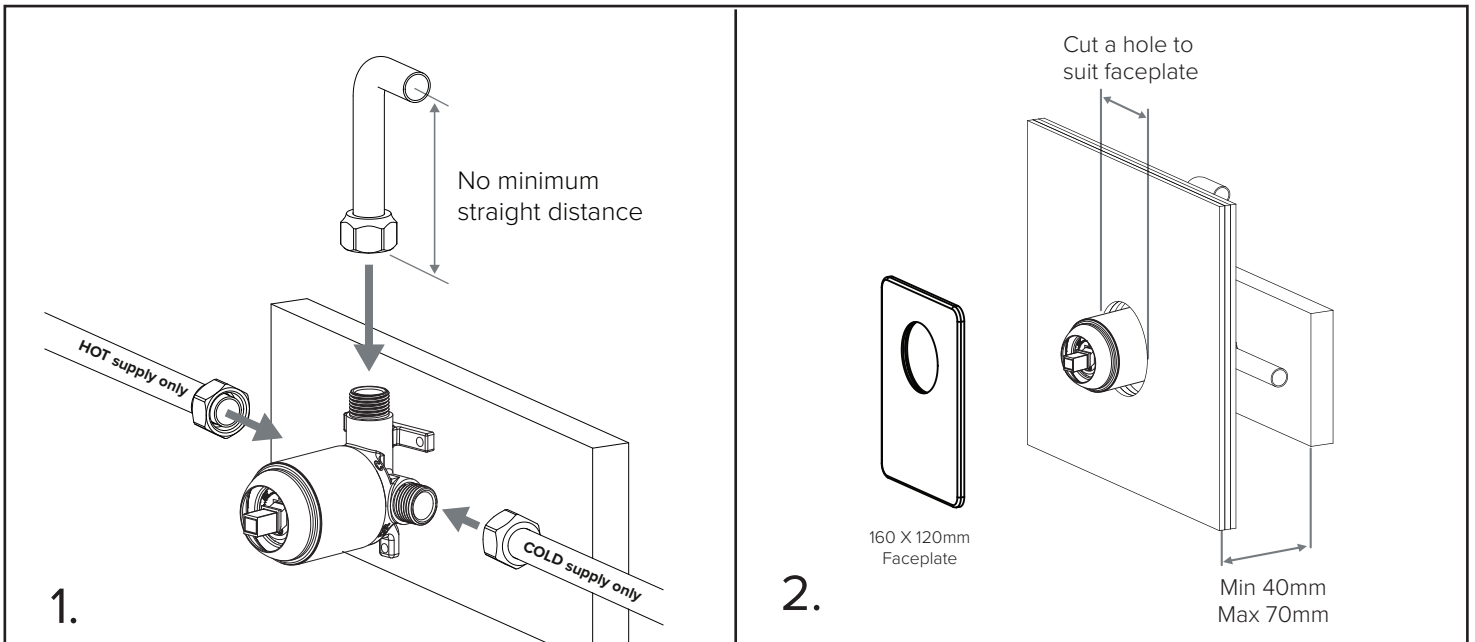

TROUBLESHOOTING - SWAPPING OUT THE VENTURI JETS

1. Remove the handle and disassemble the mixer:

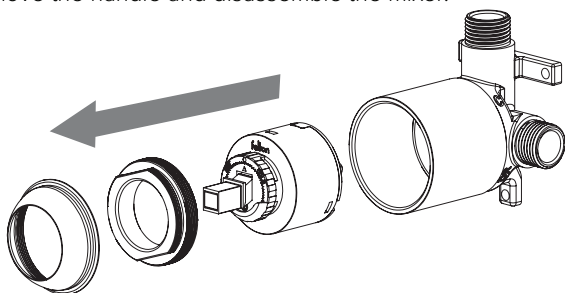

2. Remove the insert disc using long nose pliers by carefully inserting the nose of the pliers into the indicated areas A & B.

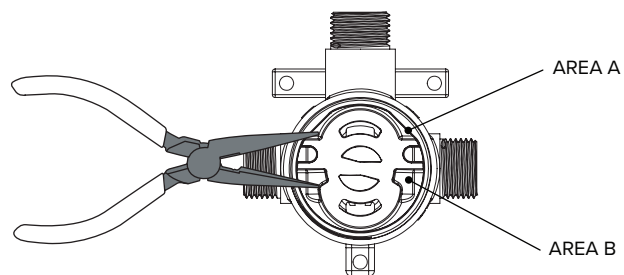

3. Unscrew the Venturi Jet using a 2.5mm Allen Key

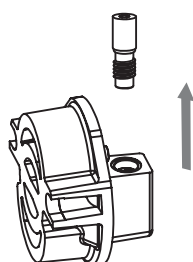

4. Refit the correct Venturi Jet into the insert disc and hand tighten firmly

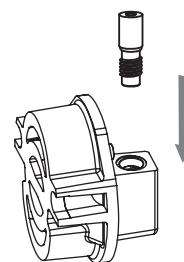

5. Refit the seal with silicone grease if required and then insert disc using the long nose pliers, ensuring that the locating pins go into the corresponding sockets.

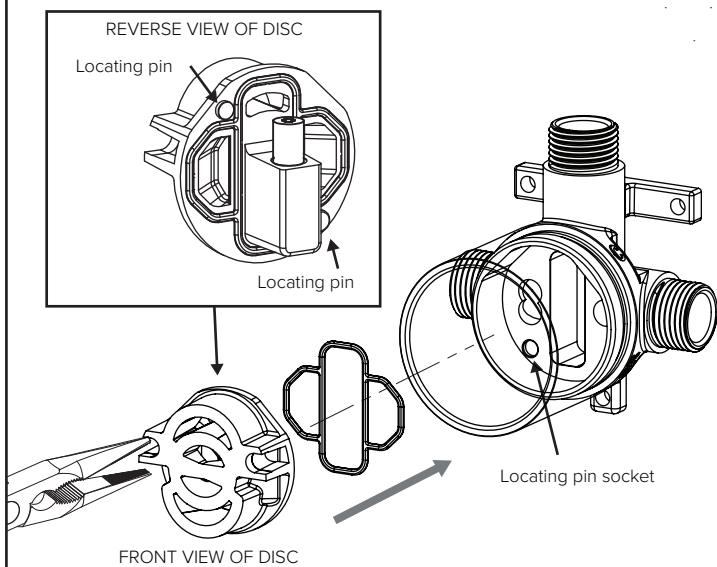

6. Reassemble mixer. Ensure that both black lines marked on the cartridge and cartridge nut are aligned when the mixer is in full cold position as shown in Figure 1.

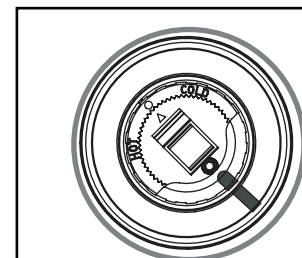
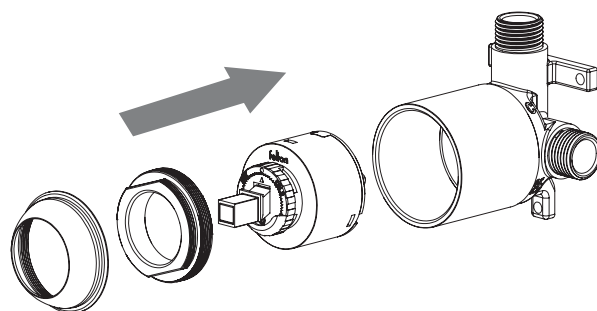

(FULL COLD POSITION)

Figure 1.

UPGRADING FROM UNEQUAL TO MAINS PRESSURE

1. Remove the handle and disassemble the mixer:

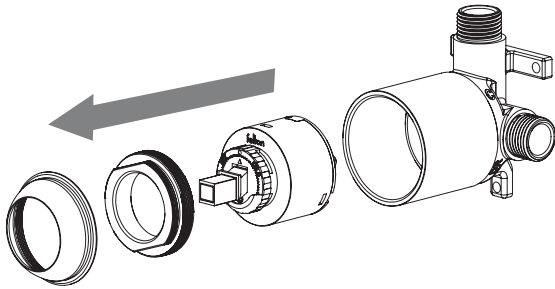

2. Remove the insert disc using long nosed pliers by carefully inserting the nose of the pliers into the indicated areas A & B.

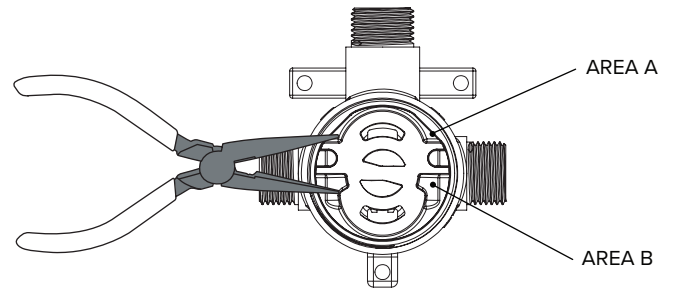

3. Unscrew the Venturi Jet using a 2.5mm Allen Key

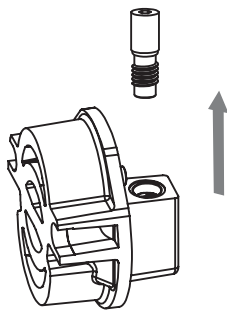

4. Refit the seal with silicone grease if required and then insert disc using the long nose pliers, ensuring that the locating pins go into the corresponding sockets.

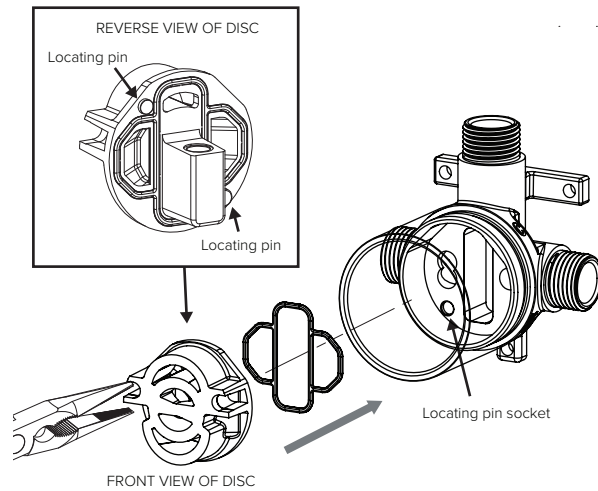

5. Reassemble mixer. Ensure that both black lines marked on the cartridge and cartridge nut are aligned when the mixer is in full cold position as shown in Figure 1.

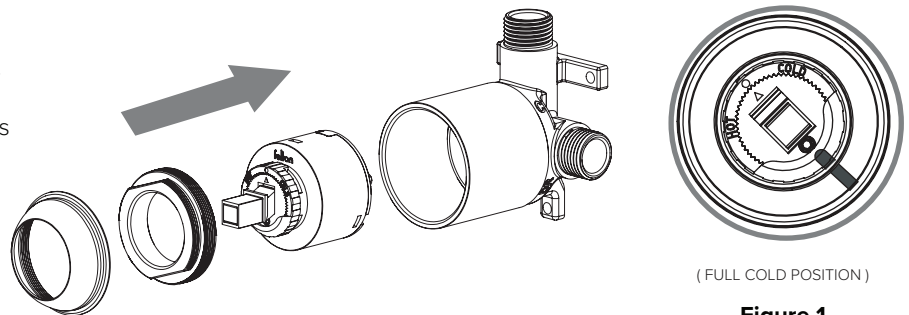

Figure 1.

MAINTENANCE - CLEANING THE FILTER

1. Follow steps 1-2 above.
2. Flush out the disc in cold water.
3. Follow steps 4-5 above.

